

PLAT OF SURVEY

A 6.804 ACRE TRACT, BEING ALL OF BLOCK 73 AND A PORTION OF BLOCKS 74, 79 AND 80 INCLUDING VACATED PORTIONS OF MINNESOTA AVENUE, THIRD STREET, AND FOURTH STREET, COLLEGE PARK ADDITION AS FILED AUGUST, 1909 IN PLAT RECORD 3, PAGE 55 OF THE DOÑA ANA COUNTY RECORDS
LOCATED WITHIN SECTION 21, TOWNSHIP 23 SOUTH, RANGE 2 EAST, N.M.P.M.
CITY OF LAS CRUCES, DOÑA ANA COUNTY, NEW MEXICO

NOTES:

- BEARINGS ARE BASED ON NEW MEXICO STATE PLANE COORDINATES CENTRAL ZONE GRID NORTH.
- DISTANCES REPORTED ARE HORIZONTAL, GROUND DISTANCES.
- RECORD BEARINGS AND DISTANCES ARE SHOWN IN PARENTHESIS WHERE APPLICABLE.
- 20' WIDE STORM DRAIN EASEMENT - FOR MAINTENANCE OF AN EXISTING SUBSURFACE STORM DRAIN FACILITY OF UNKNOWN SIZE. LOCATION INFORMATION FOR PORTIONS OF THIS FACILITY NOT ASCERTAINABLE FROM FIELD OBSERVED EVIDENCE PROVIDED BY NMSU STAFF.
- THIS PARCEL(S) OF LAND IS IN FLOOD ZONE "X" OF THE FEDERAL EMERGENCY MANAGEMENT AGENCY'S FLOOD INSURANCE RATE MAPS (FIRM 35013C1111 G) DATED 7/6/2016.
- ADDITIONAL DOCUMENTS USED:
 - WARRANTY DEED: REC# 8611133, FILED 6/10/1986
 - POWER'S TRACTS, FILED 11/6/1998 IN PLAT BOOK 19, PAGE 198
 - POWER'S TRACTS, REPLAT NO. 1, FILED 5/4/2006 IN PLAT BOOK 21, PAGE 608
 - COLLEGE PARK ADDITION, FILED 8/8/1909 IN PLAT BOOK 3, PAGE 55
 - COLLEGE PARK ADDITION NO. 4 REPLAT, FILED 5/20/1969 IN PLAT BOOK 10, PAGE 54
 - SONMAR SUBDIVISION, FILED 3/14/1996 IN PLAT BOOK 18, PAGE 433
 - UNFILED PLAT OF SURVEY OF A 12.69 ACRE TRACT BY BLANCHARD ENGINEERING, INC. OBTAINED FROM DAVID BLANCHARD, CERTIFIED 11/8/2006.
 - VARIOUS PLATS, DESCRIPTIONS, FIELD NOTES, ETC., FROM THE DONALD H. WIESE COMPANY SURVEY RECORDS, SPECIFICALLY FILES CONTAINED IN BOX NO. 124 OF MANUSCRIPT COLLECTION #0463, LOCATED IN ARCHIVES AND SPECIAL COLLECTIONS, NEW MEXICO STATE UNIVERSITY LIBRARY.
 - VARIOUS PLATS, DESCRIPTIONS, FIELD NOTES, ETC., FROM THE LAND GROUP INC. SURVEY RECORDS, SPECIFICALLY FILES CONTAINED IN BOXES NUMBERED 8 AND 9 OF MANUSCRIPT COLLECTION #0477, LOCATED IN ARCHIVES AND SPECIAL COLLECTIONS, NEW MEXICO STATE UNIVERSITY LIBRARY.

SURVEYOR'S CERTIFICATION

I, BENJAMIN L. CARTER, A NEW MEXICO PROFESSIONAL SURVEYOR, CERTIFY THAT THIS SURVEY PLAT AND THE FIELD SURVEY UPON WHICH IT IS BASED WERE PERFORMED BY ME OR UNDER MY DIRECT SUPERVISION; THAT I AM RESPONSIBLE FOR THIS SURVEY; THAT THIS SURVEY IS TRUE AND CORRECT TO THE BEST OF MY KNOWLEDGE AND BELIEF, AND THAT THIS SURVEY AND PLAT MEET THE MINIMUM STANDARDS FOR SURVEYING IN NEW MEXICO. I FURTHER CERTIFY THAT THIS SURVEY IS NOT A LAND DIVISION OR SUBDIVISION AS DEFINED BY THE NEW MEXICO SUBDIVISION ACT AND THAT THIS INSTRUMENT IS A BOUNDARY SURVEY PLAT OF AN EXISTING TRACT OR TRACTS.

B. L. Carter
BENJAMIN L. CARTER, PS 22648

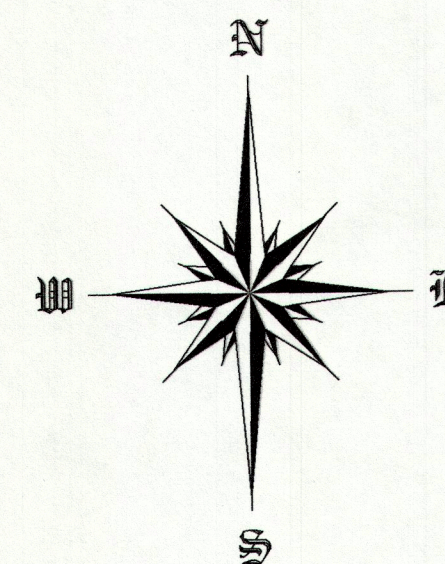
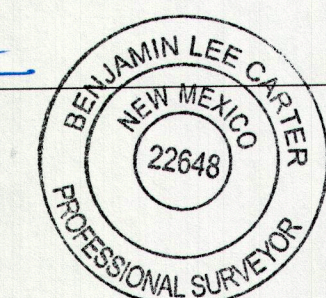

0 100' 200'
SCALE: 1" = 100'

LEGEND

- FOUND 1/2" IRON ROD - NO CAP UNLESS OTHERWISE NOTED
- ⊙ FOUND 1/2" IRON ROD WITH CAP AS NOTED
- ✕ CHISELED "X" IN SIDEWALK

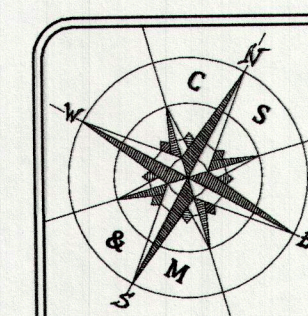

CARTER SURVEYING AND MAPPING

3267 View Drive Las Cruces, New Mexico 88011
Phone (575) 313-2638
Carter.Surveying1@gmail.com

PROJECT NAME:

PLAT OF SURVEY - 6.804 ACRES

DATE: 11/2/2018

PROJECT NUMBER: 18233

SHEET 1 OF 1